

GENERAL NOTES:
 MANHOLE DESIGN
 SPECIFICATIONS CON-
 FORM TO LATEST A.S.T.M.
 C478 SPEC. FOR "PRE-
 CAST REINFORCED CONCRETE
 MANHOLE SECTIONS.

DESIGN LOADING: AASHTO
 HS20-44



FLOW RATE: 0 - 99 GPM (4" VALVE)
 FLOW RATE: 0 - 240 GPM (6" VALVE)
 FLOW RATE: 0 - 500 GPM (8" VALVE)

(*Note: above flow rates are estimates and
 require specific project information for design)

INTERIOR OF BASE SECTION TO BE LINED WITH GSE, HDPE "Studliner"

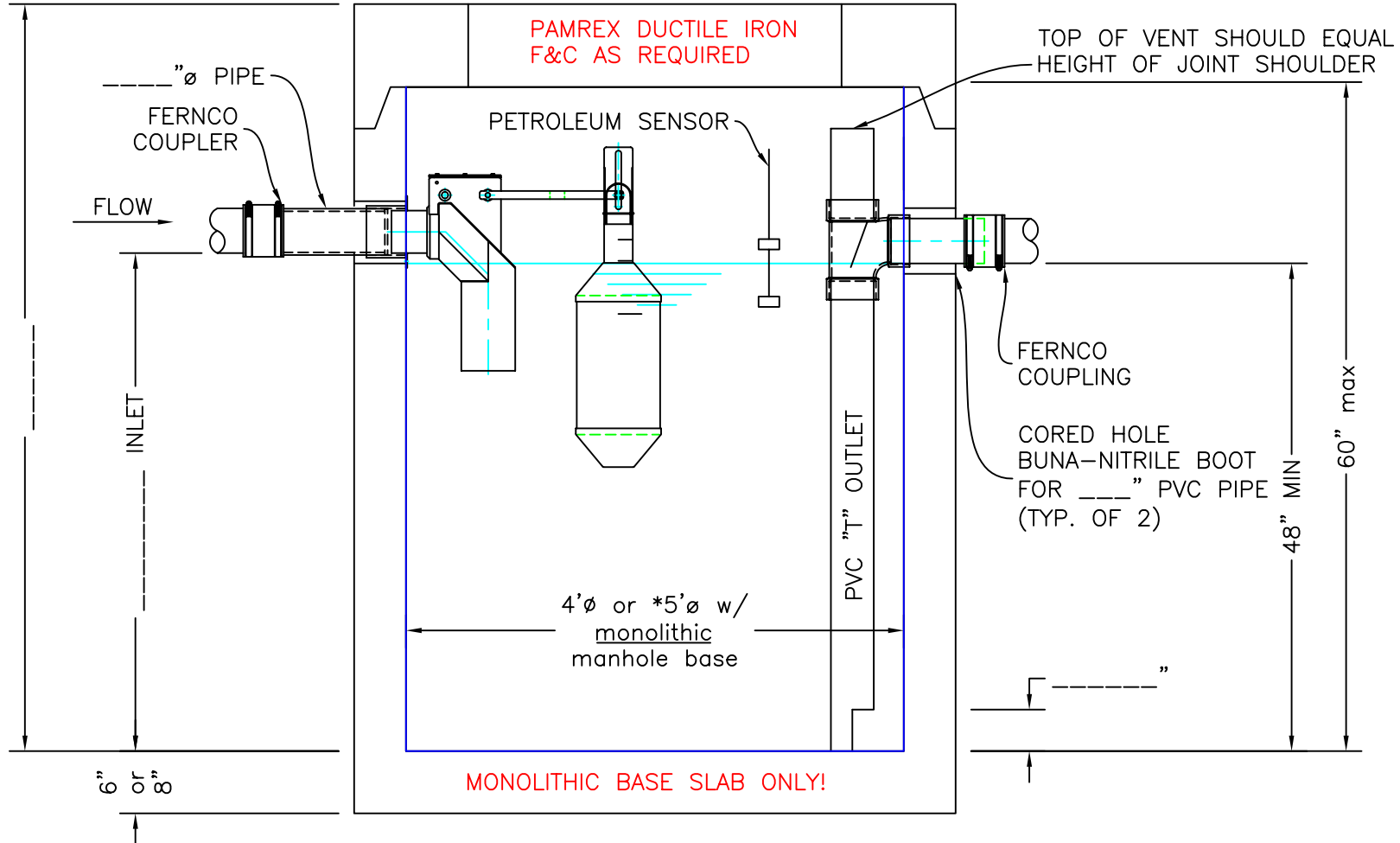

NOTE:
 UNIT DEPTH DETERMINED BY PROJECT
 SPECIFICATIONS AND ELEVATIONS.

REVISIONS



PROJECT:	ECOSTOP SPILL CONTROL SYS DWG - GENERIC		
LOCATION:			
OWNER:			
ENGINEER:			
CONTRACTOR:			
MANUFACTURER:			
PRODUCT DESIGNATION:	ECOSTOP ___" VALVE		
SCALE:	N/A	DRAWN BY:	JGS
DATE:	01-09-07	DWG. NO.:	eStop_gen_07
DESIGNED BY:	JGS	CHECK 1:	
		CHECK 2:	